

PER MONTH

**£1,400 Per Month**  
**Cornwall Road**

London, N15 5AH

EPC RATING: COUNCIL TAX BAND: B



**Turners Court**

Approximate Gross Internal Area = 587 sq ft / 54.5 sq m

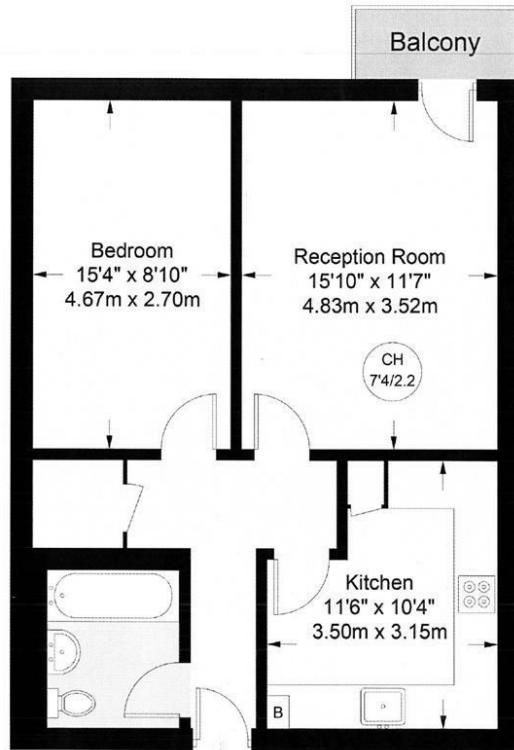

This plan is for layout guidance only. Not drawn to scale unless stated. Windows and door openings are approximate. Whilst every care is taken in the preparation of this plan, please check all dimensions, shapes and compass bearings before making any decisions reliant upon them. (ID603854)



Energy Efficiency Rating		Current	Potential
Very energy efficient - lower running costs			
(92 plus)	A		
(81-91)	B		
(69-80)	C		
(55-68)	D		
(39-54)	E		
(21-38)	F		
(1-20)	G		
Not energy efficient - higher running costs			
<b>England &amp; Wales</b>		EU Directive 2002/91/EC	



Agents Note: Whilst every care has been taken to prepare these particulars, they are for guidance purposes only. All measurements are approximate and are for general guidance purposes only and whilst every care has been taken to ensure their accuracy, they should not be relied upon and potential buyers/tenants are advised to recheck the measurements

**Paul Simon**  
Estate agents

**OFFICE ADDRESS**  
786-788 Green Lanes  
London  
N21 3RE

**OFFICE DETAILS**  
0208 800 1155  
management@paul-simon.co.uk